

## アモルファスシリコン太陽電池 仕様

Model : AM-5610C-T

## 1. Outside dimensions 外形寸法

Light Receiving Side (受光面)

Overcoat Side (オーバーコート面)

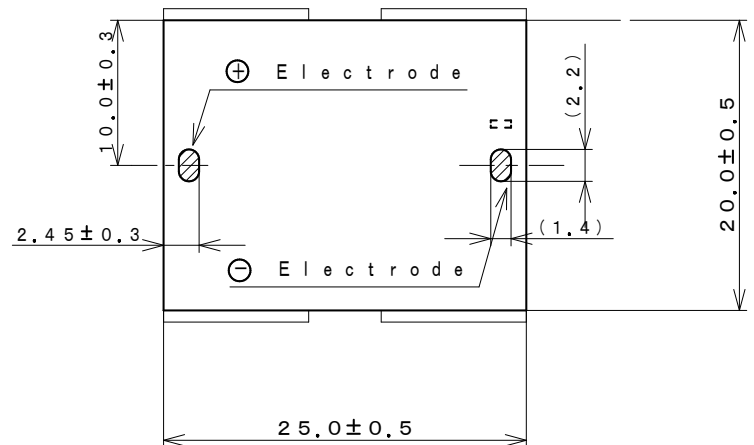
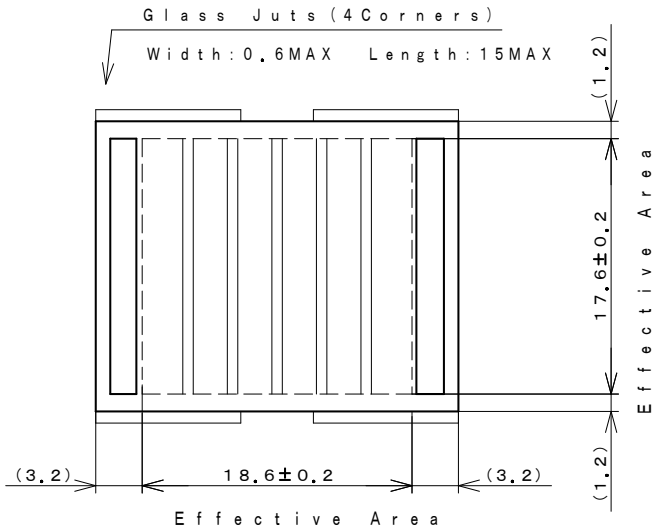

(dimension : mm)

## Note

Glass Substrate Thickness (ガラス基板厚) : 1.6 mm ± 0.2

Module Thickness (モジュール厚) : 2.0 mm MAX

Accepts normal soldering for bending

(一般の半田を使用してリート線付けが可能です。)

## 2. Rated Specifications (at 25°C)

Item	Specifications (Initial)		
2.1 Open circuit voltage : Voc 開放電圧	Typical	5.1 V	at 50 kLx SS
2.2 Short circuit Current : Isc 短絡電流	Typical	2.4 mA	at 50 kLx SS
2.3 Operating Voltage & Operating Current : Vope - Iope 動作特性	Minimum	3.0 V - 1.7 mA	at 50 kLx SS
	Typical	3.3 V - 2.3 mA	at 50 kLx SS
	Typical	3.3 V - 5.1 mA	at AM-1.5 100 mW/cm <sup>2</sup>
2.4 Maximum output : Pmax & optimum operating Volt : Vop optimum operating Current : Iop 最大出力	(reference)	8 mW	Vop = 3.9 V Iop = 2.2 mA at 50 kLx SS
	(reference)	18 mW	Vop = 3.9 V Iop = 4.6 mA at AM-1.5 100 mW/cm <sup>2</sup>
2.5 Working temperature range : Topr 動作温度範囲		-10 to 60°C	
2.6 Storage temperature range : Tstg 保存温度範囲		-20 to 70°C	

SS: Solar Simulator

アモルファスシリコン太陽電池 仕様

Model : AM-5610CAR-T

1. Outside dimensions 外形寸法

Light Receiving Side (受光面)

Overcoat Side (オーバーコート面)

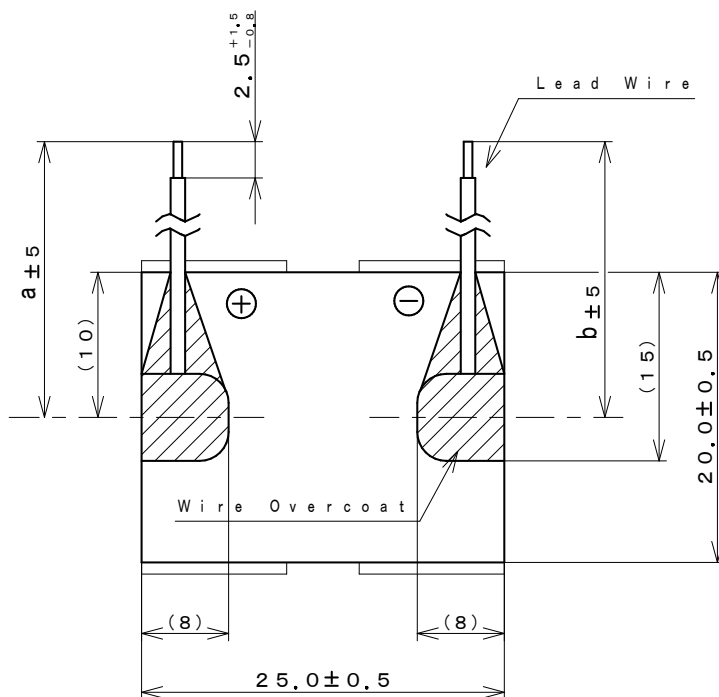
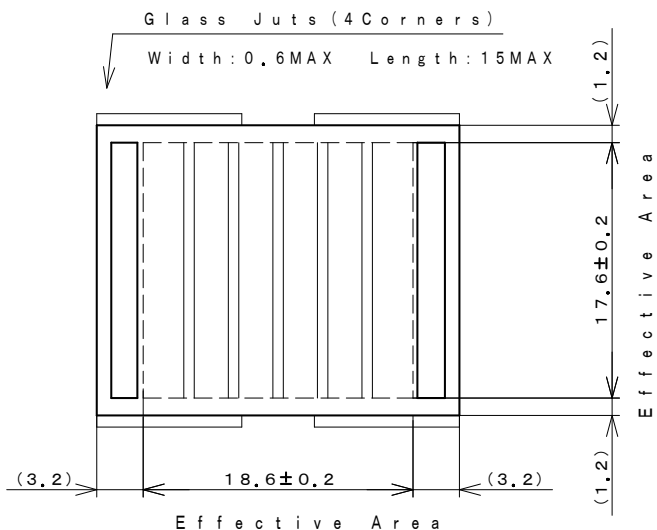

(dimension : mm)

Lead Wires : AWG28	
a : 70	b : 70

Note

Glass Substrate Thickness (ガラス基板厚) :  $1.6 \text{ mm} \pm 0.2$

Module Thickness (モジュール厚) :  $2.0 \text{ mm MAX}$

Wire-Overcoat Thickness :  $3.1 \text{ mm MAX}$  (including Module)  
(リード線補正コート厚)

2. Rated Specifications (at 25°C)

Item	Specifications (Initial)		
2.1 Open circuit voltage : Voc 開放電圧	Typical	5.1V	at 50kLx SS
2.2 Short circuit Current : Isc 短絡電流	Typical	2.4mA	at 50kLx SS
2.3 Operating Voltage & Operating Current : Vope-Iope 動作特性	Minimum	3.0V - 1.7mA	at 50kLx SS
	Typical	3.3V - 2.3mA	at 50kLx SS
	Typical	3.3V - 5.1mA	at AM-1.5 100mW/cm <sup>2</sup>
2.4 Maximum output : Pmax & optimum operating Volt : Vop optimum operating Current : Iop 最大出力	(reference)	8mW	Vop=3.9V Iop=2.2mA at 50kLx SS
	(reference)	18mW	Vop=3.9V Iop=4.6mA at AM-1.5 100mW/cm <sup>2</sup>
2.5 Working temperature range : Topr 動作温度範囲		-10 to 60°C	
2.6 Storage temperature range : Tstg 保存温度範囲		-20 to 70°C	

SS: Solar Simulator

# I - V Characteristics

REFERENCE

1.Model : AM-5610

2.Outside Dimension : 25.0mm × 20.0mm

SS:Solar Simulator

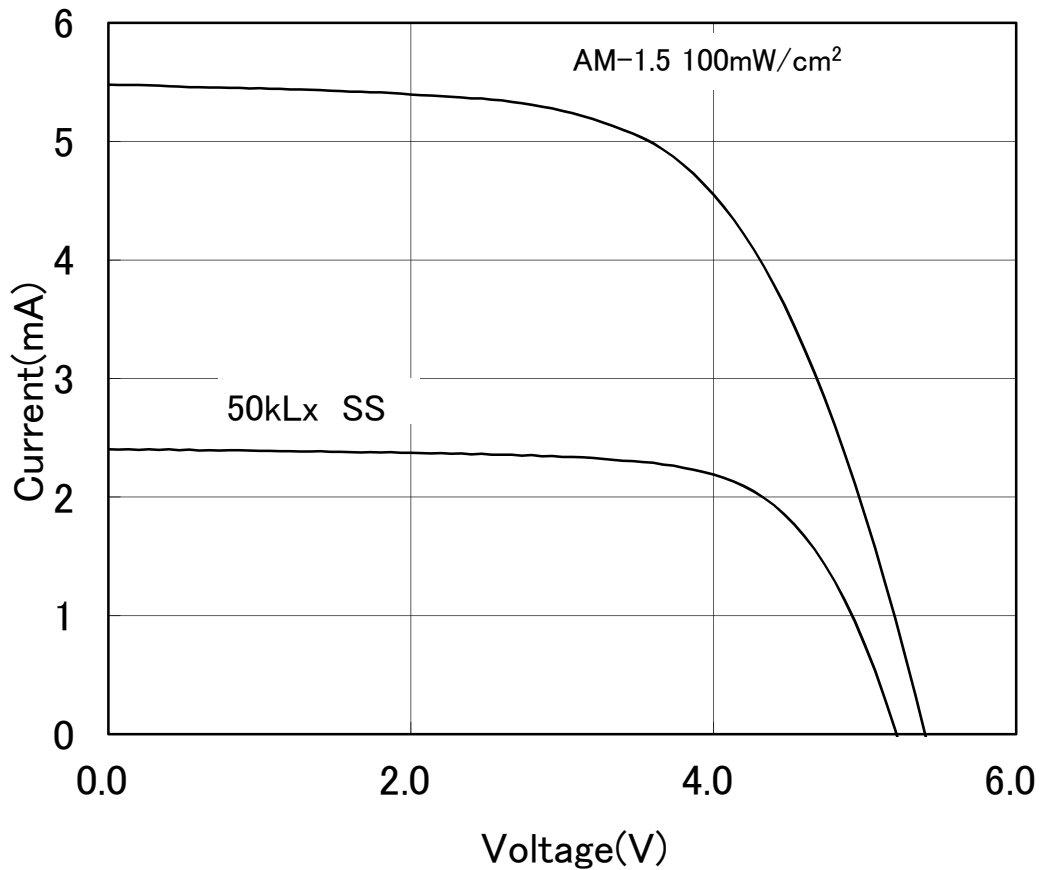

\*このデータは標準的な出力特性を示すものであり、特性を保証するものではありません。

\*The data are meant to show standard electric characteristics only , not intended to guarantee the characteristics.

Panasonic Solar Amorton Co.,Ltd.

2019/5/20

# 出力の照度依存特性

REFERENCE

Dependence of Output on Illumination

1.Model : AM-5610

2.Outside Dimension : 25.0mm × 20.0mm

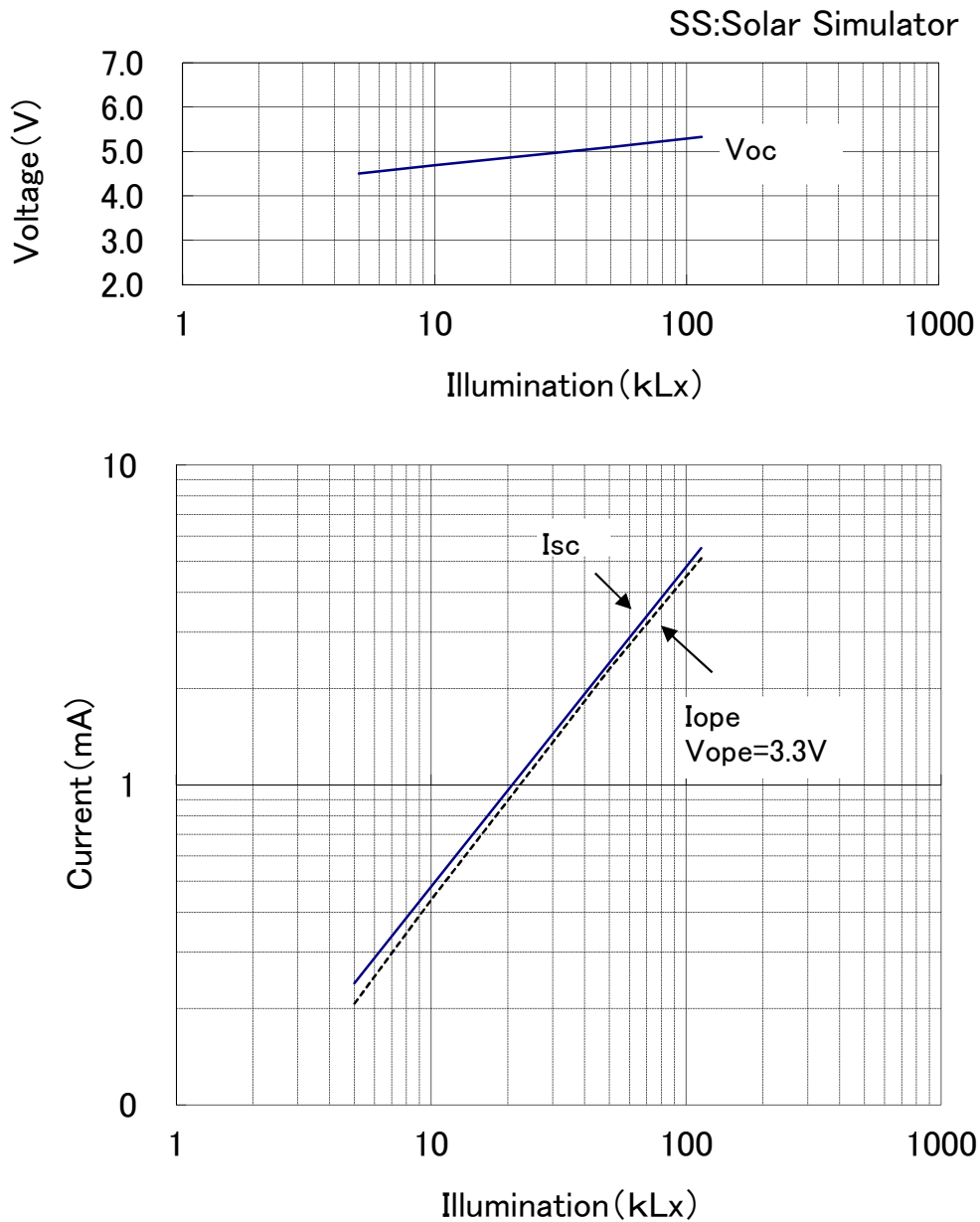

\*このデータは標準的な出力特性を示すものであり、特性を保証するものではありません。

\*The data are meant to show standard electric characteristics only , not intended to guarantee the characteristics.

Panasonic Solar Amorton Co.,Ltd.

2019/5/20

# 出力の温度依存特性

REFERENCE

Dependence of Output on Temperature

1.Model : AM-5610

2.Outside Dimension : 25.0mm × 20.0mm

AM-1.5 10mW/cm<sup>2</sup>

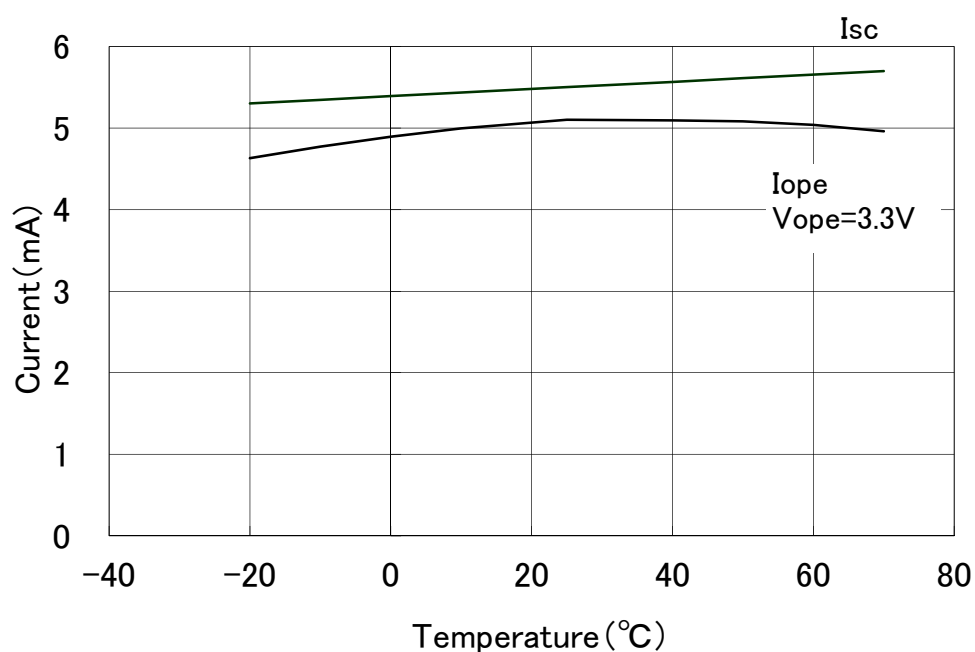
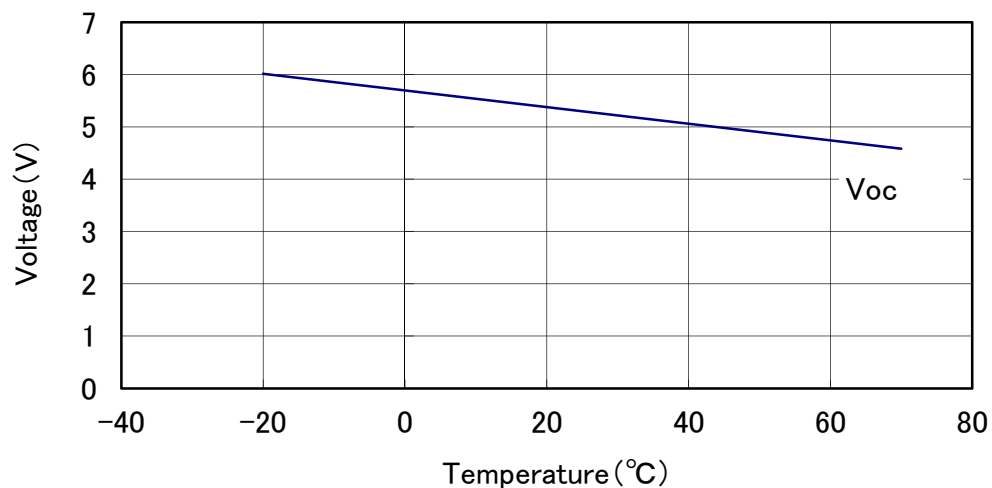

\*このデータは標準的な出力特性を示すものであり、特性を保証するものではありません。

\*The data are meant to show standard electric characteristics only , not intended to guarantee the characteristics.