

## アモルファスシリコン太陽電池 仕様

Model : AM-5914C-T

## 1. Outside dimensions 外形寸法

Light Receiving Side (受光面)

Overcoat Side (オーバーコート面)

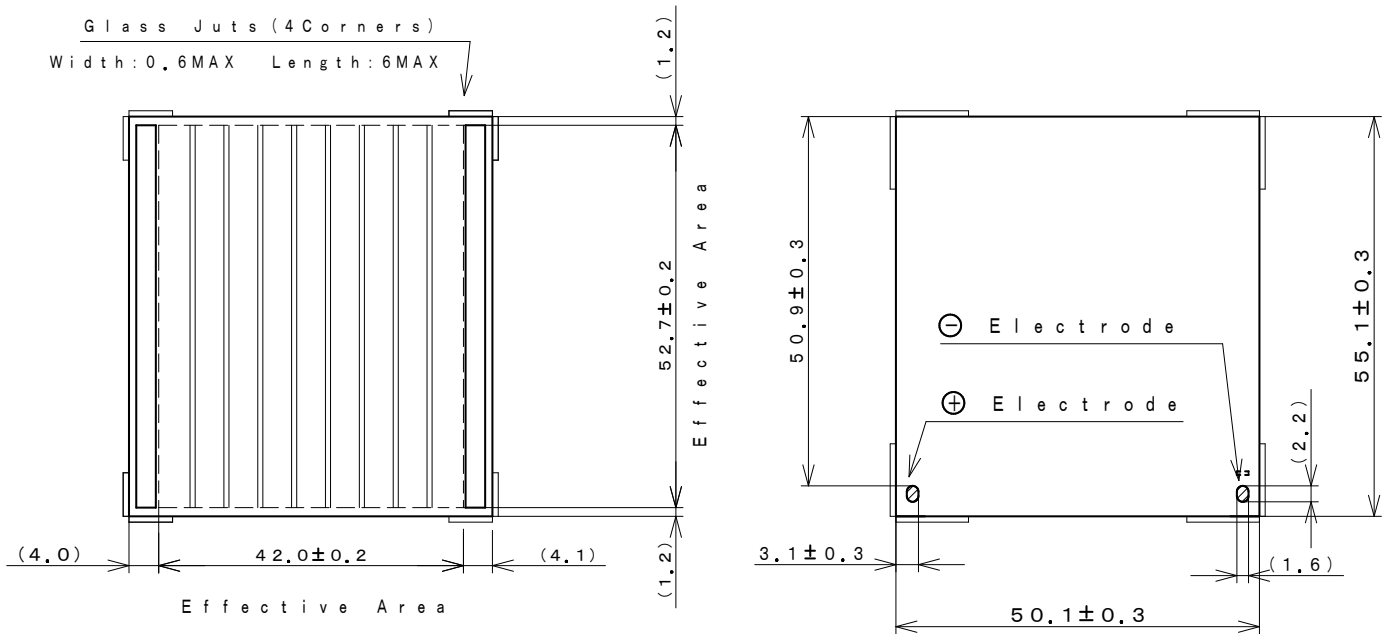

(dimension : mm)

## Note

Glass Substrate Thickness (ガラス基板厚) : 1.6mm ± 0.2

Module Thickness (モジュール厚) : 2.0mmMAX

Accepts normal soldering for bending

(一般の半田を使用してリード線付けが可能です。)

## 2. Rated Specifications (at 25℃)

Item	Specifications (Initial)		
2.1 Open circuit voltage : Voc 開放電圧	Typical	7.7V	at 50kLx SS
2.2 Short circuit Current : Isc 短絡電流	Typical	11.4mA	at 50kLx SS
2.3 Operating Voltage & Operating Current : Vope - Iope 動作特性	Minimum	4.5V - 8.1mA	at 50kLx SS
	Typical	5.0V - 10.6mA	at 50kLx SS
	Typical	5.0V - 23.1mA	at AM-1.5 100mW/cm <sup>2</sup>
2.4 Maximum output : Pmax & optimum operating Volt : Vop optimum operating Current : Iop 最大出力	(reference)	57mW	Vop = 5.9V Iop = 9.7mA at 50kLx SS
	(reference)	121mW	Vop = 5.9V Iop = 20.4mA at AM-1.5 100mW/cm <sup>2</sup>
2.5 Working temperature range : Topr 動作温度範囲		-10 to 60℃	
2.6 Storage temperature range : Tstg 保存温度範囲		-20 to 70℃	

SS: Solar Simulator

## アモルファスシリコン太陽電池 仕様

Model : AM-5914CAR-T

## 1. Outside dimensions 外形寸法

Light Receiving Side (受光面)

Overcoat Side (オーバーコート面)

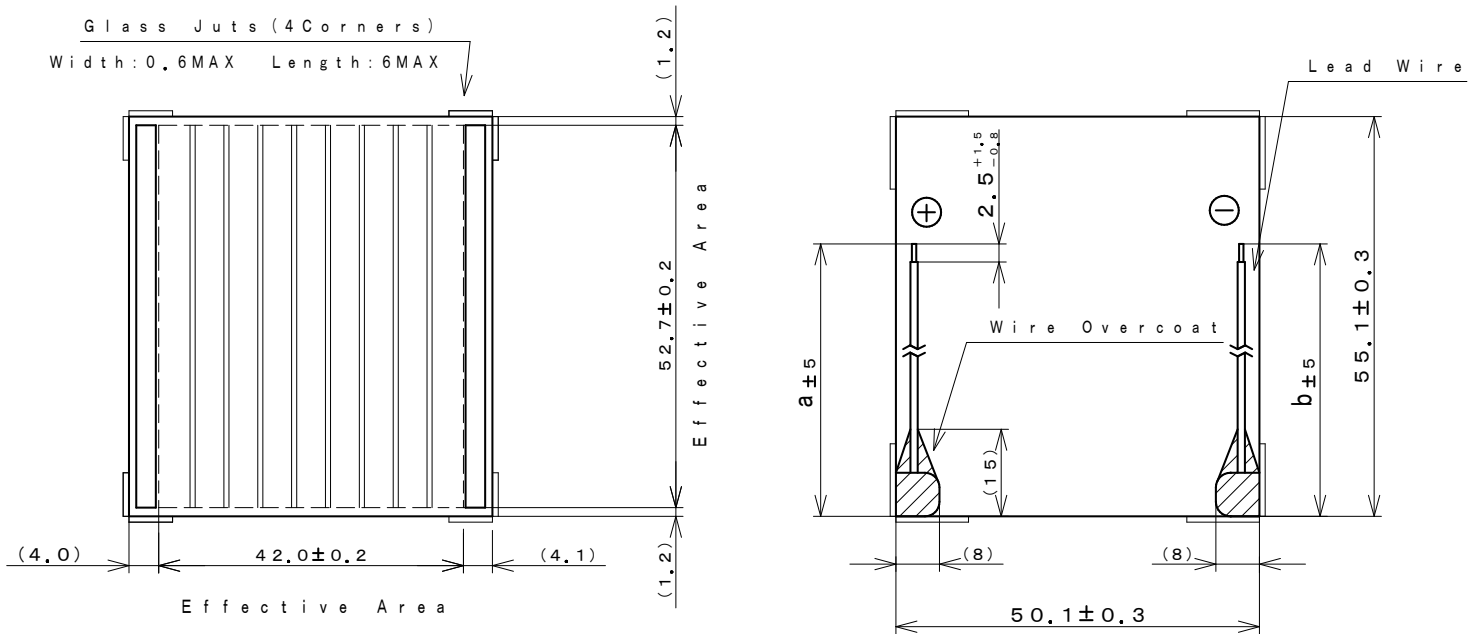

(dimension : mm)

Lead Wires : AWG30	
a : 74	b : 74

## Note

Glass Substrate Thickness (ガラス基板厚) :  $1.6\text{mm} \pm 0.2$ Module Thickness (モジュール厚) :  $2.0\text{mm MAX}$ Wire-Overcoat Thickness :  $3.1\text{mm MAX}$  (including Module)  
(リード線補正コート厚)

## 2. Rated Specifications (at 25℃)

Item	Specifications (Initial)
2.1 Open circuit voltage : Voc 開放電圧	Typical 7.7V at 50kLx SS
2.2 Short circuit Current : Isc 短絡電流	Typical 11.4mA at 50kLx SS
2.3 Operating Voltage & Operating Current : Vope-Iope 動作特性	Minimum 4.5V - 8.1mA at 50kLx SS
	Typical 5.0V - 10.6mA at 50kLx SS
	Typical 5.0V - 23.1mA at AM-1.5 100mW/cm <sup>2</sup>
2.4 Maximum output : Pmax & optimum operating Volt : Vop optimum operating Current : Iop 最大出力	(reference) 57mW $V_{op}=5.9V$ $I_{op}=9.7mA$ at 50kLx SS
	(reference) 121mW $V_{op}=5.9V$ $I_{op}=20.4mA$ at AM-1.5 100mW/cm <sup>2</sup>
2.5 Working temperature range : Topr 動作温度範囲	-10 to 60℃
2.6 Storage temperature range : Tstg 保存温度範囲	-20 to 70℃

# I - V Characteristics

REFERENCE

1.Model : AM-5914

2.Outside Dimension : 50.1mm × 55.1mm

SS:Solar Simulator

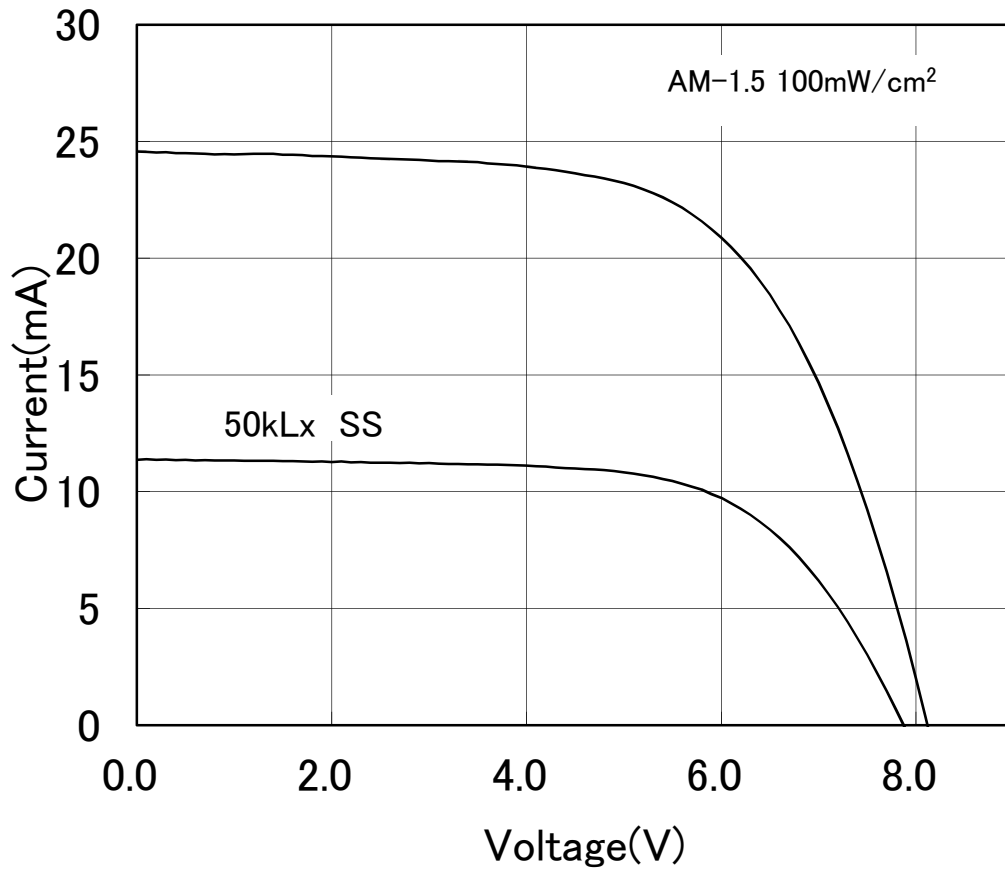

\*このデータは標準的な出力特性を示すものであり、特性を保証するものではありません。

\*The data are meant to show standard electric characteristics only , not intended to guarantee the characteristics.

Panasonic Solar Amorton Co.,Ltd.

2019/7/4

# 出力の照度依存特性

REFERENCE

Dependence of Output on Illumination

1.Model : AM-5914

2.Outside Dimension : 50.1mm × 55.1mm

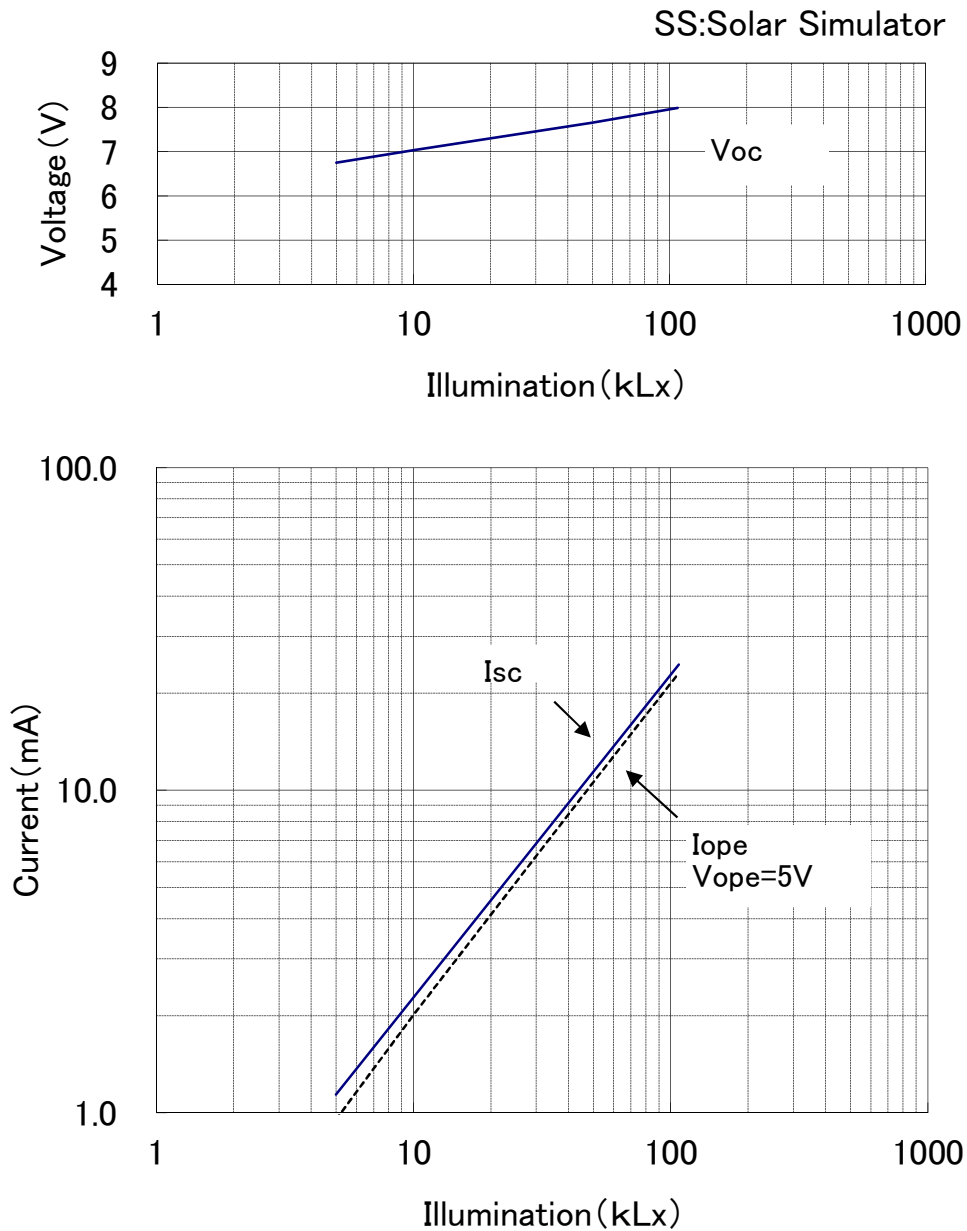

\*このデータは標準的な出力特性を示すものであり、特性を保証するものではありません。

\*The data are meant to show standard electric characteristics only , not intended to guarantee the characteristics.

# 出力の温度依存特性

REFERENCE

Dependence of Output on Temperature

1.Model : AM-5914

2.Outside Dimension : 50.1mm × 55.1mm

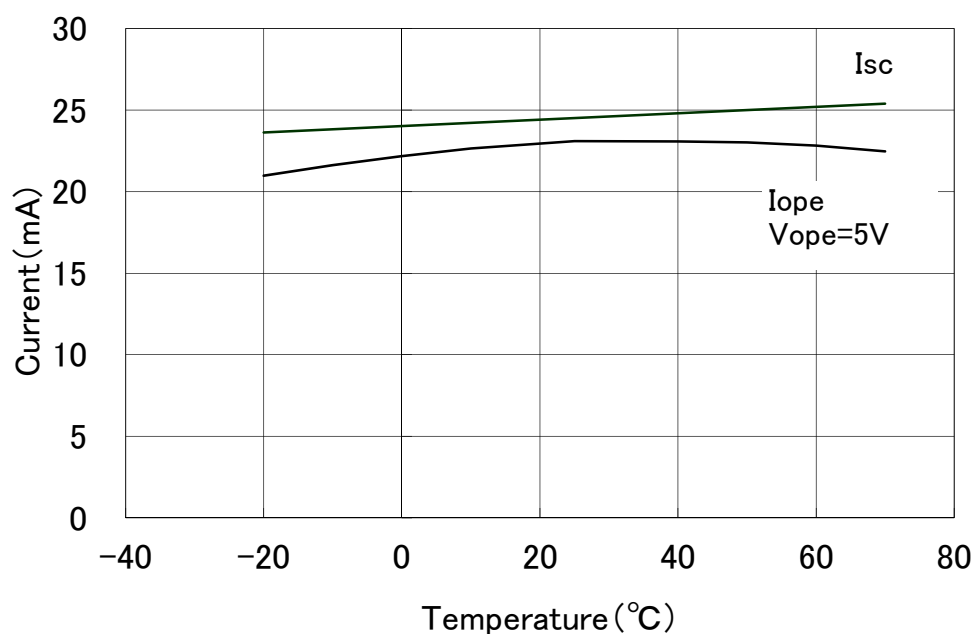
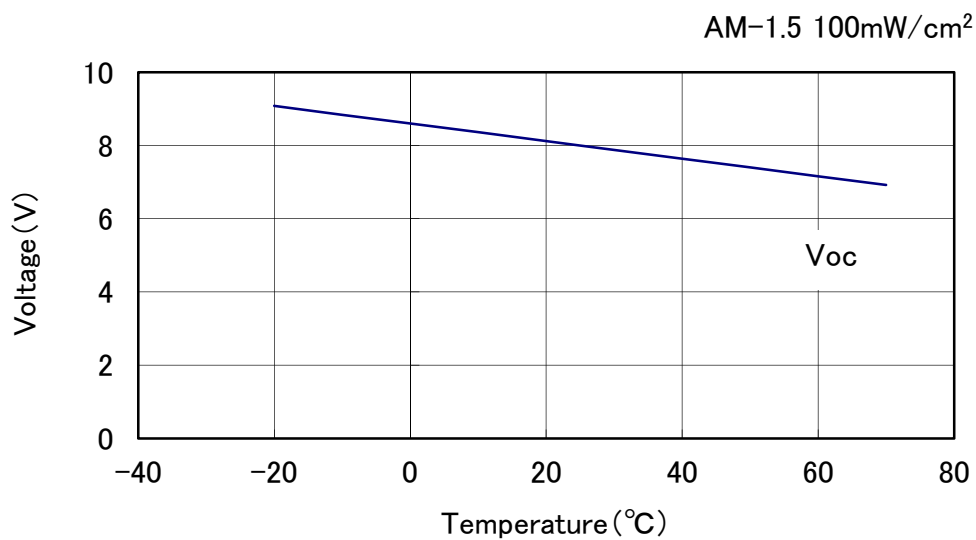

\*このデータは標準的な出力特性を示すものであり、特性を保証するものではありません。

\*The data are meant to show standard electric characteristics only , not intended to guarantee the characteristics.